



**marantz®**

**CD Receiver M-CR610**

Quick Setup Guide

**Start Here**  
**Commencez ici**  
**Iniciar aquí**



# Before you begin

## What's In The Box

---

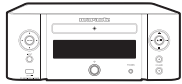

M-CR610



Power cord

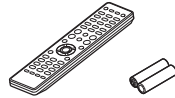

Remote and batteries



Product manual  
on CD-ROM



AM loop antenna

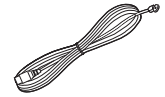

FM indoor  
antenna

## Required For Setup

---



Network router

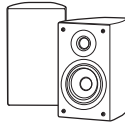

Speakers



Speaker cables

## Optional

---

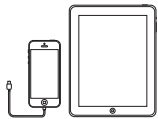

iOS device and  
USB cable



Router with WPS



Network cable

\* For detailed instructions or assistance, please refer to the enclosed CD-ROM manual or visit our support site: [www.marantz.com](http://www.marantz.com)

# 1. Connection

- 1** Connect the left and right speakers to the M-CR610

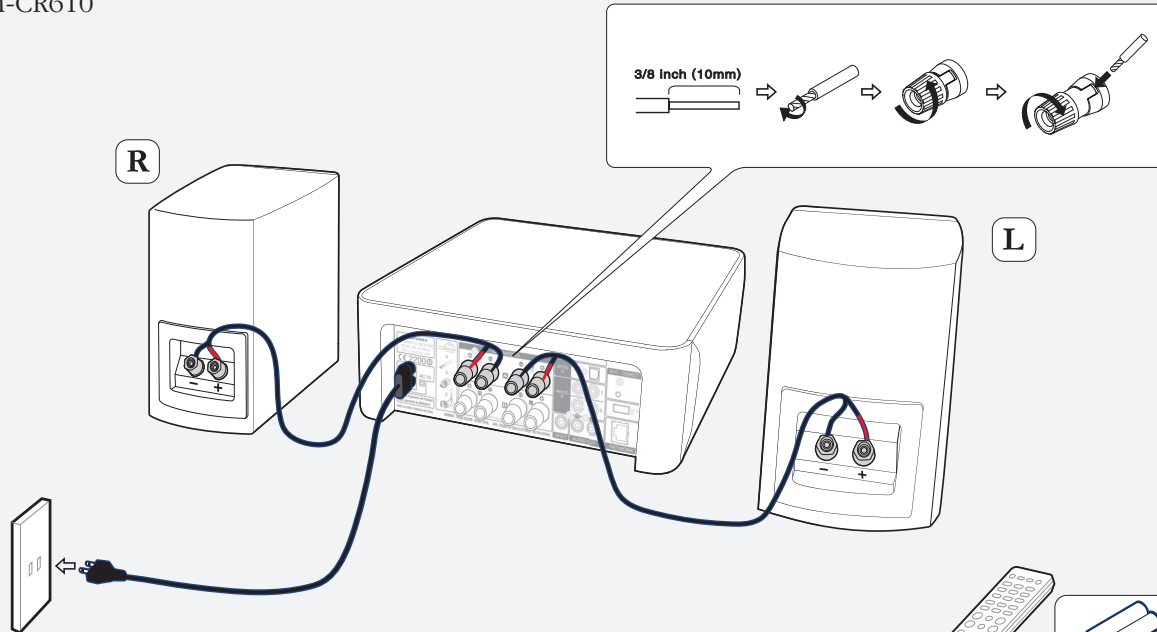

- 2** Connect the power cord from the M-CR610 to a power outlet

- 3** Insert the batteries into the remote

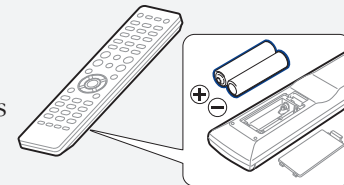

Note: Please refer to the CD-ROM manual for Speaker A/B and Bi-amp connection options.





## 2. Connecting to your home network

Choose from one of the following options

**Wireless**

**iOS device + USB cable**

**1** Power on **2** Select language **3** Make sure your iOS device is already connected to your WiFi Network then connect your iOS device to the front using your USB cable.  
Note: You must be running iOS version 5 or later





**No WPS router**

**1** Power on **2** Select language **3** Auto scan  
Please wait as your M-CR610 looks for available networks...

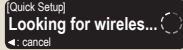

Wi-Fi router





**WPS router**

**1** Power on **2** Select language **3** Press the WPS button on your router



Wi-Fi router

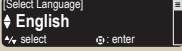

**Wired**

**1** Connect a network cable between your M-CR610 and your router (cable not included) **2** Power on

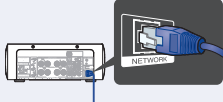
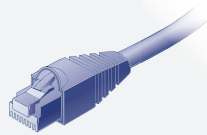

**4** Press the red Wi-Fi CONNECT Button on the back of your M-CR610



**5** This message will appear on your iOS device  
Select "Allow"



Connected!

## Network Control

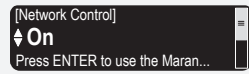

Select Network Control ON to control M-CR610 from your smartphone, use Apple AirPlay® and maintain constant network access. Power Consumption during standby power will be slightly higher.

**4** Select your network name  
If your network name is not listed, select "Rescan"



**5** Enter your network password using the number keys on the remote control



Connected!

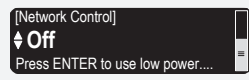

Select Network Control OFF to reduce power consumption during standby. You can not turn on your M-CR610 from your smartphone or use Apple AirPlay until your M-CR610 is powered on manually and connects to your network.

**4** Within 2 minutes, Press and Hold the red Wi-Fi CONNECT button on the back of your M-CR610 for 3 seconds



**5** Please wait as completing the connection can take a few minutes  
The front panel of the M-CR610 will show the status of the connection

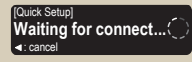

Connected!

**3** Select language

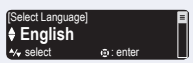

**4** Please wait while your M-CR610 connects to your wired network.

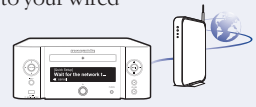

Connected!

## Setup Complete!

# 3. Enjoying your music!

## Enjoying Internet radio

- 1 Press the “INTERNET RADIO” button on the remote

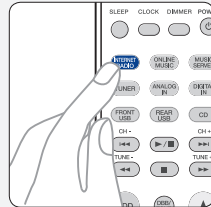

- 2 Select a station

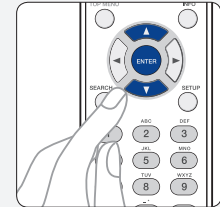

## Enjoying music using Apple AirPlay

- 1 Tap the AirPlay Icon from within any app that supports AirPlay

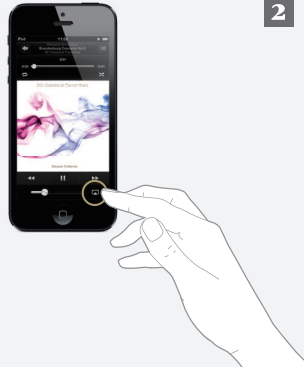

- 2 Select the “Marantz M-CR610” from the AirPlay Device list

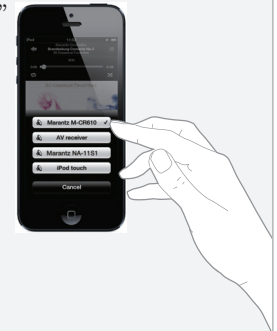

Note: Make sure your iOS device is on the same network as the M-CR610

## Download the Marantz Remote App

Scan the QR code to download and install the Marantz Remote App using your smartphone and a scanning app or manually search the Apple App store or Google Play store for the “Marantz Remote App”

